

# DOĞANTARLA KÖYÜ KOCATEPE MAHALLESİ DÜZENLEME PROJE UYGULAMA SINIR KROKİSİ

BOZDOĞAN HARİTA İNŞ. BLŞ. LTD. ŞTİ.

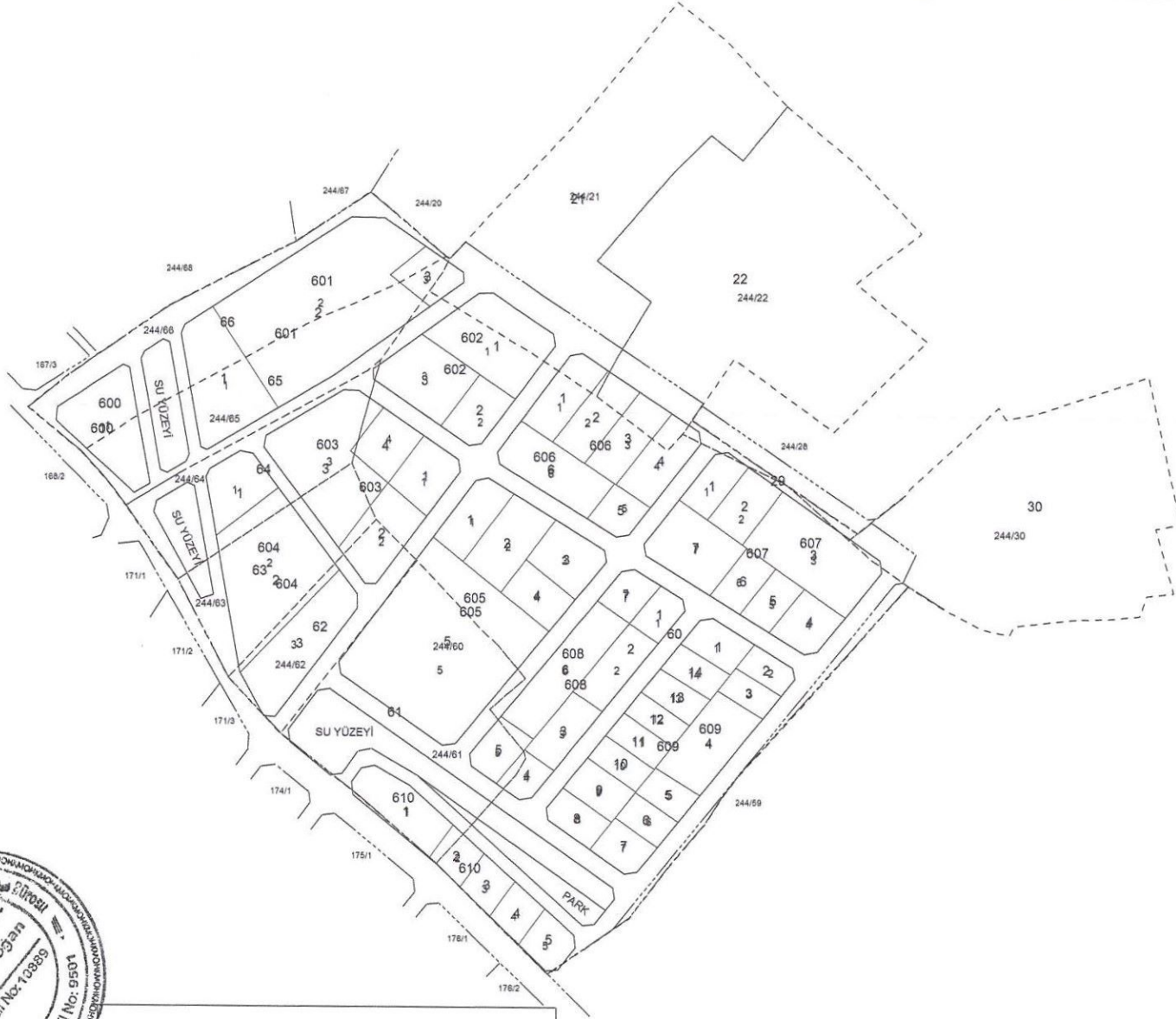

KROKİ



UYGUNDUR  
ÖZEL İDARE / KADASTRO

KONTROL EDEN

ONAYLAYAN

ADI SOYADI

BOZDOĞAN

Tarih

Harita İnş. Blş. Bas. Yay. Gıda San. ve Tic. Ltd. Şti.  
Hamidiye Mah. 7/1 Atatürk Bul. No:95A

İmza

İç Kapı No: 1 / 1 / ANSARAY  
Aksaray V.D. No: 1830651555 Tic. Sic. No: 8546  
Mersis No: 0183065155500010

DÜZENLEME SINIRI

İMAR PARSELİ

İMAR ADASI

PASİF PARSEL

Netcad 6.0 GIS for Windows

TOPLAM ALAN : 163366.67  
TOPLAM PAY : 163366.67  
TOPLAM KAMULAŞTIRMA : 0.00  
OP. DÜZENLE. GİRMEYEN: 50920.70  
OP. DÜZENLEMeye GİREN: 112445.97

MAL SAHİPLERİ ARAŞTIRMA  
VE  
ÖZET FORMU  
( KADASTRO PARSELİNE SIRALI )

SAYFA NO: 1

TOPLAM ADA ALANI : 77244.93  
O.KATILIM ORANI : 0.0000000  
D.O.PAYI ORANI : 0.3130485

K A D A S T R O

İ M A R

SNo	Pafta	Ada/Par	Alan/Pay	Hisse	Malik/Baba Adı	Kamu	Dop/İTh	Ada/Par	Alan	Hisse	Pay
1	L32-A-14-C	244/21	16821.0 16821.0	TAM	SAİT ÇAĞLAYAN OSMAN	-	1104.75 2424.25	602/1	2424.25	TAM	2424.25
2	L32-A-14-C	244/22	21880.8 21880.8	TAM	NURETTİN ÜNLÜ RAŞİT	-	538.92 1182.59	606/4	1182.59	TAM	1182.59
3	L32-A-14-C	244/29	458.23 458.23	TAM	ELİF ÇOBAN RAŞİT	-	143.45 314.78	607/1	731.18	31478/73118	314.78
4	L32-A-14-C	244/30	17363.3 17363.3	TAM	İLYAS GÖKŞEN MEHMET	-	189.75 416.40	607/1	731.18	41640/73118	416.40
5	L32-A-14-C	244/60	58771.6 14692.9	192 768	HİKMET SAK OSMAN	-	4543.86 9971.01	602/2 603/1 607/2 607/4 608/1 608/3 608/4 608/7 609/5 609/6 609/10 609/11 609/12 610/2 610/3	883.57 1000.58 911.93 856.08 594.17 874.57 500.00 541.15 552.38 540.01 550.00 550.01 510.35 550.00 556.21	TAM TAM TAM TAM TAM TAM TAM TAM TAM TAM TAM TAM TAM TAM TAM	883.57 1000.58 911.93 856.08 594.17 874.57 500.00 541.15 552.38 540.01 550.00 550.01 510.35 550.00 556.21
12	L32-A-14-C	244/60	58771.6 459.16	6 768	HÜSNİYE SAK EROL	-	142.00 311.60	608/6	1904.18	31160/190418	311.60
13	L32-A-14-C	244/60	58771.6 969.32	19 1152	ORHAN SAK MUSTAFA	-	299.77 657.80	609/7	657.80	TAM	657.80
14	L32-A-14-C	244/60	58771.6 969.32	19 1152	FADİMA ANA İN MUSTAFA	-	299.77 657.80	609/8	657.80	TAM	657.80
15	L32-A-14-C	244/60	58771.6 1173.39	23 1152	MUSTAFA SAK RAFET	-	362.88 796.29	608/6	1904.18	79629/190418	796.29
16	L32-A-14-C	244/60	58771.6 1173.39	23 1152	ŞEYMA SAK RAFET	-	362.88 796.29	608/6	1904.18	79629/190418	796.29
17	L32-A-14-C	244/60	58771.6 10152.3	199 1152	NAİLE YÖN MUSTAFA	-	3139.68 6889.69	601/3 603/2 607/6 608/2 608/5 609/2 609/3 609/9 610/4	767.42 1428.26 669.04 1000.00 721.38 500.00 500.00 742.91 560.68	TAM TAM TAM TAM TAM TAM TAM TAM TAM	767.42 1428.26 669.04 1000.00 721.38 500.00 500.00 742.91 560.68
18	L32-A-14-C	244/60	58771.6 5815.94	19 192	MEVLÜT SAK MUSTAFA	-	1798.60 3946.86	606/5 607/3 607/5	596.74 2717.84 632.28	TAM TAM TAM	596.74 2717.84 632.28
19	L32-A-14-C	244/60	58771.6 9795.27	1 6	FAHRETTİN BİŞKİN ETHEM  AYSEL ÜNLÜ [Vrs.] FAHRETTİN AYHAN BİŞKİN [Vrs.] FAHRETTİN HATİCE DİK [Vrs.] FAHRETTİN	-	3029.23 6647.34	602/3 606/6 607/7 609/4	1661.84 1661.84 1661.82 1661.84	TAM TAM TAM TAM	1661.84 1661.84 1661.82 1661.84
23	L32-A-14-C	244/60	58771.6 3775.26	37 576	SULTAN İSMİK MUSTAFA	-	1167.51 2562.00	609/1 609/13 609/14 610/5	713.99 590.21 600.00 657.80	TAM TAM TAM TAM	713.99 590.21 600.00 657.80
24	L32-A-14-C	244/60	58771.6 9795.27	1 6	FADİME BOZLAK MEHMET ALİ  FATMA İSMİK [Vrs.] MEHMET ALİ ERDOĞAN SAK [Vrs.] MEHMET ALİ	-	3029.23 6647.34	605/2 605/3 605/4 606/1 606/2 606/3	1384.86 1107.89 830.92 1107.89 1107.89 1107.89	TAM TAM TAM TAM TAM TAM	1384.86 1107.89 830.92 1107.89 1107.89 1107.89



**BOZDOĞAN**  
Harita İnş. Bilis. Bas. Yay. Gıda San. ve Tic. Ltd. Şti.  
Hamidiye Mah. 7/Antakya Bul. No:95A  
İç Kapı No: 1 Merkez / AKSARAY  
Aksaray V.D. No: 1830651556 Tic. Sic. No: 8546  
Mersis No: 0183065155500010

TOPLAM ALAN : 163366.67  
 TOPLAM PAY : 163366.67  
 TOPLAM KAMULAŞTIRMA : 0.00  
 ÖP. DÜZENLE. GİRMİYEN: 50920.70  
 ÖP. DÜZENLEMeye GİREN: 112445.97

MAL SAHİPLERİ ARAŞTIRMA  
 VE  
 ÖZET FORMU  
 ( KADASTRO PARSELİNE SIRALI )

TOPLAM ADA ALANI : 77244.93  
 O.KATILIM ORANI : 0.0000000  
 D.O.PAYI ORANI : 0.3130485

K A D A S T R O							İ M A R				
No	Pafta	Ada/Par	Alan/Pay	Hisse	Malik/Baba Adı	Kamu	Dop/İth	Ada/Par	Alan	Hisse	Pay
					TAHSİN SAK [Vrs.] MEHMET ALİ İLHAN SAK [Vrs.] MEHMET ALİ AHMET SAK [Vrs.] İMDAT						
6	L32-A-14-C	244/61	12836.1 12836.1	TAM	SAYIT ÇAĞLAYAN OSMAN	-	4018.33 8817.81	605/5 610/1	7445.30 1372.51	TAM TAM	7445.30 1372.51
7	L32-A-14-C	244/62	4671.39 4671.39	TAM	ABDURRAHMAN BERK AHMET	-	1462.37 3209.02	604/3 605/1	2205.01 1004.01	TAM TAM	2205.01 1004.01
8	L32-A-14-C	244/63	5636.41 78.30	7830 563641	ÜLKÜ BÜLBÜL İSMET	-	24.51 53.79	604/2	3871.94	5379/387194	53.79
30	L32-A-14-C	244/63	5636.41 156.57	15657 563641	SELMA BERK İSMET	-	49.01 107.56	604/2	3871.94	10756/387194	107.56
31	L32-A-14-C	244/63	5636.41 156.57	15657 563641	HASAN HÜSEYİN BERK İSMET	-	49.01 107.56	604/2	3871.94	10756/387194	107.56
32	L32-A-14-C	244/63	5636.41 156.57	15657 563641	FİDAN ERDOĞAN İSMET	-	49.01 107.56	604/2	3871.94	10756/387194	107.56
33	L32-A-14-C	244/63	5636.41 156.55	15655 563641	SULTAN BIÇE İSMET	-	49.00 107.55	604/2	3871.94	10755/387194	107.55
34	L32-A-14-C	244/63	5636.41 156.57	15657 563641	SEVDA AKBAYIR İSMET	-	49.01 107.56	604/2	3871.94	10756/387194	107.56
35	L32-A-14-C	244/63	5636.41 187.88	18788 563641	EMİNE BIÇE İSMAİL	-	58.81 129.07	604/2	3871.94	12907/387194	129.07
36	L32-A-14-C	244/63	5636.41 187.88	18788 563641	NECLA MAY İSMAİL	-	58.81 129.07	604/2	3871.94	12907/387194	129.07
37	L32-A-14-C	244/63	5636.41 187.88	18788 563641	RAHİME KARA İSMAİL	-	58.81 129.07	604/2	3871.94	12907/387194	129.07
38	L32-A-14-C	244/63	5636.41 187.88	18788 563641	ADEM BERK İSMAİL	-	58.81 129.07	604/2	3871.94	12907/387194	129.07
39	L32-A-14-C	244/63	5636.41 187.88	18788 563641	AFETTİN BERK İSMAİL	-	58.81 129.07	604/2	3871.94	12907/387194	129.07
40	L32-A-14-C	244/63	5636.41 78.28	7828 563641	FATMA BERK ÇİFTÇİ YUSUF	-	24.51 53.77	604/2	3871.94	5377/387194	53.77
41	L32-A-14-C	244/63	5636.41 78.28	7828 563641	FUNDA TEOMAN YUSUF	-	24.51 53.77	604/2	3871.94	5377/387194	53.77
42	L32-A-14-C	244/63	5636.41 78.28	7828 563641	GÜLDEN ÇAVDAR İSMET	-	24.51 53.77	604/2	3871.94	5377/387194	53.77
43	L32-A-14-C	244/63	5636.41 78.28	7828 563641	ÜLGEN ÇAVDAR İSMET	-	24.51 53.77	604/2	3871.94	5377/387194	53.77
44	L32-A-14-C	244/63	5636.41 156.57	15657 563641	MUSTAFA BERK İSMET	-	49.02 107.55	604/2	3871.94	10755/387194	107.55
45	L32-A-14-C	244/63	5636.41 234.85	23485 563641	İLKNUR AYTAZ HALİL	-	73.52 161.33	604/2	3871.94	16133/387194	161.33
46	L32-A-14-C	244/63	5636.41 78.28	7828 563641	SEDA BERK SÜLEYMAN	-	24.51 53.77	604/2	3871.94	5377/387194	53.77
47	L32-A-14-C	244/63	5636.41 234.85	23485 563641	AYNUR AKMAN HALİL	-	73.52 161.33	604/2	3871.94	16133/387194	161.33
48	L32-A-14-C	244/63	5636.41 330.63	33063 563641	AHMET BERK CELALETTİN	-	103.51 227.12	604/2	3871.94	22712/387194	227.12
49	L32-A-14-C	244/63	5636.41 313.13	31313 563641	KAZIM ÖN İSMAİL	-	98.03 215.10	604/2	3871.94	21510/387194	215.10
50	L32-A-14-C	244/63	5636.41 313.13	31313 563641	MAHMUT ÖN İSMAİL	-	98.03 215.10	604/2	3871.94	21510/387194	215.10
51	L32-A-14-C	244/63	5636.41 313.14	31314 563641	ALİ ÖN İSMAİL	-	98.03 215.11	604/2	3871.94	21511/387194	215.11
52	L32-A-14-C	244/63	5636.41	60878	AYŞE BERK	-	190.58	604/2	3871.94	41820/387194	418.20



**BOZDOĞAN**  
 Harita İnş. Biliş. Eas. Yay. Gıda ve Tic. Ltd. Şti.  
 Hamidiye Mah. 7/Atatürk Bul. No:95A  
 İç Kapı No: 1 Merkez / AKSARAY  
 Aksaray V.D. No: 1830691559 Tic. Sic. No: 8546  
 Mersis No: 0187066155500010

TOPLAM ALAN : 163366.67  
TOPLAM PAY : 163366.67  
TOPLAM KAMULAŞTIRMA : 0.00  
TOP. DÜZENLE. GİRMEYEN: 50920.70  
TOP. DÜZENLEMESİNE GİREN: 112445.97

MAL SAHİPLERİ ARAŞTIRMA  
VE  
ÖZET FORMU  
( KADASTRO PARSELİNE SIRALI )

SAYFA NO: 3

TOPLAM ADA ALANI : 77244.93  
O.KATILIM ORANI : 0.0000000  
D.O.PAYI ORANI : 0.3130485

K A D A S T R O

İ M A R

SNo	Pafta	Ada/Par	Alan/Pay	Hisse	Malik/Baba Adı	Kamu	Dop/İth	Ada/Par	Alan	Hisse	Pay
			608.78	563641	HALİL		418.20				
53	L32-A-14-C	244/63	5636.41 939.40	93940 563641	GÜLZADE ÖZDİN ALİ FATİMANA BERK [Vrs.] ALİ	-	294.08 645.32	604/2	3871.94	64532/387194	645.32
9	L32-A-14-C	244/64	6530.89 6530.89	TAM	GÜLZADE ÖZDİN ALİ FATİMANA BERK [Vrs.] ALİ ÜLGEN ÇAVDAR [Vrs.] İSMET ÜLKÜ BÜLBÜL [Vrs.] İSMET GÜLDEN ÇAVDAR [Vrs.] İSMET FUNDA TEOMAN [Vrs.] YUSUF FATMA BERK ÇİFTÇİ [Vrs.] YUSUF SEDA BERK [Vrs.] SÜLEYMAN AHMET BERK [Vrs.] CELALETTİN KAZIM ÖN [Vrs.] İSMAİL MAHMUT ÖN [Vrs.] İSMAİL ALİ ÖN [Vrs.] İSMAİL AYŞE BERK [Vrs.] HALİL NAIL BERK [Vrs.] MEMİŞ RAZİYE BERK [Vrs.] NAIL CELAL BERK [Vrs.] NAIL MEHME ALİ BERK [Vrs.] NAIL FATMA BERK [Vrs.] İSMAİL RAZİYE BERK [Vrs.] MEMİŞ NEZİHA ÖN [Vrs.] MEVLÜT ZEYNEP BERK [Vrs.] MEVLÜT ELMAS KONUK [Vrs.] MEVLÜT AYNUR AKMAN [Vrs.] HALİL İLKNUYR AYTAR [Vrs.] HALİL EMİNE BİÇE [Vrs.] İSMAİL NECLA MAY [Vrs.] İSMAİL RAHİME KARA [Vrs.] İSMAİL ADEM BERK [Vrs.] İSMAİL AFETTİN BERK [Vrs.] İSMAİL MUSTAFA BERK [Vrs.] İSMET SELMA BERK [Vrs.] İSMET HASAN HÜSEYİN BERK İSMET FİDAN ERDOĞAN [Vrs.] İSMET SULTAN BİÇE [Vrs.] İSMET SEVDA AKBAYIR [Vrs.] İSMET	-	2044.49 4486.40	603/3 604/1	3365.58 1120.82	TAM TAM	3365.58 1120.82
10	L32-A-14-C	244/65	7850.70 1308.46	48 288	HATİCE YANBAŞ İSMAİL	-	409.62 898.84	601/1	2428.86	89884/242886	898.84
55	L32-A-14-C	244/65	7850.70 1308.45	48 288	MUSTAFA BİÇE İSMAİL	-	409.62 898.84		2428.86	89884/242886	898.84

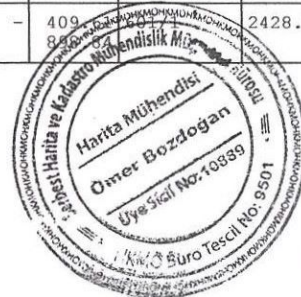

BOZDOĞAN  
Harita İnş. Biliş. Bas. Yay. Gıda San. ve Tic. Ltd. Şti.  
Hamidiye Mah. 7/Atatürk Bul. No:95A  
İç Kapı No: 1 Merkez AKSARAY  
Aksaray V.D. No: 1830651555 Tic. Sic. No: 8546  
Mersis No: 0183065155500010

TOPLAM ALAN : 163366.67		M A L S A H İ P L E R İ A R A Ş T I R M A					SAYFA NO: 4				
TOPLAM PAY : 163366.67		V E					TOPLAM ADA ALANI : 77244.93				
TOPLAM KAMULAŞTIRMA : 0.00		Ö Z E T F O R M U					O.KATILIM ORANI : 0.0000000				
TOP. DÜZENLE. GİRMEYEN: 50920.70		( KADASTRO PARSELİNE SIRALI )					D.O.PAYI ORANI : 0.3130485				
TOP. DÜZENLEMEME GİREN: 112445.97											
K A D A S T R O						İ M A R					
SNo	Pafta	Ada/Par	Alan/Pay	Hisse	Malik/Baba Adı	Kamu	Dop/İTh	Ada/Par	Alan	Hisse	Pay
56	L32-A-14-C	244/65	7850.70 1308.45	48 288	RAİF BİÇE İSMAİL	-	409.61 898.84	600/1 601/1	2065.35 2428.86	26766/206535 63118/242886	267.66 631.18
57	L32-A-14-C	244/65	7850.70 1308.45	48 288	HİLMİ BİÇE HAKKI	-	409.61 898.84	603/4	898.84	TAM	898.84
58	L32-A-14-C	244/65	7850.70 245.33	9 288	KAMİLE BİÇE NECİP	-	76.81 168.52	600/1	2065.35	16852/206535	168.52
59	L32-A-14-C	244/65	7850.70 354.37	13 288	HÜSEYİN BİÇE RECEP	-	110.93 243.44	600/1	2065.35	24344/206535	243.44
60	L32-A-14-C	244/65	7850.70 354.37	13 288	İHSAN BİÇE RECEP	-	110.93 243.44	600/1	2065.35	24344/206535	243.44
61	L32-A-14-C	244/65	7850.70 354.37	13 288	HATİCE BUT RECEP	-	110.93 243.44	600/1	2065.35	24344/206535	243.44
64	L32-A-14-C	244/65	7850.70 1308.45	1 6	HAKKI BİÇE TAHSİN RASİM BİÇE [Vrs.] TAHSİN FERİDE TOK [Vrs.] TAHSİN SEDAKAT BİÇE [Vrs.] TAHSİN İSMET BİÇE [Vrs.] HİLMİ AHMET BİÇE [Vrs.] HİLMİ HAKKI BİÇE [Vrs.] HİLMİ MUHLİSE MAY [Vrs.] HİLMİ SANİYE DAL [Vrs.] HİLMİ ÜMÜŞ DAL [Vrs.] HİLMİ NARİN UZ [Vrs.] HİLMİ GÜLSEREN BİÇE [Vrs.] NAZİFİ ALBULKADİR BİÇE [Vrs] KASIM HAKİM BİÇE [Vrs.] KASIM NURAY TOK [Vrs.] KASIM MUKTEBER BİÇE TOK [V KASIM	-	409.60 898.85	600/1	2065.35	89885/206535	898.85
11	L32-A-14-C	244/66	10546.1 2109.23	1 5	HATİCE BATUR DEDE	-	660.30 1448.93	601/2	7244.67	144893/724467	1448.93
78	L32-A-14-C	244/66	10546.1 2109.23	1 5	ARZI BİÇE DEDE	-	660.30 1448.93	601/2	7244.67	144893/724467	1448.93
79	L32-A-14-C	244/66	10546.1 2109.22	1 5	AYŞE BOZLAK KANBER EKREM OKŞAŞ [Vrs.] KANBER OSMAN OKŞAŞ [Vrs.] KANBER CELAL OKŞAŞ [Vrs.] KANBER DURALİ OKŞAŞ [Vrs.] KANBER HATİCE BATUR [Vrs.] BÜNYAMİN OSMAN BATUR [Vrs.] BÜNYAMİN	-	660.29 1448.93	601/2	7244.67	144893/724467	1448.93
86	L32-A-14-C	244/66	10546.1 2109.22	1 5	MUSTAFA BOZLAK ALİ YAŞAR BOZLAK [Vrs.] ALİ SEYİT AHMET BOZLAK [V ALİ DUDU OKŞAŞ [Vrs.] ALİ SANİYE OKŞAŞ [Vrs.] ALİ	-	660.28 1448.94	601/2	7244.67	144894/724467	1448.94



**BOZDOĞAN**  
Harita İnş. Bilgi. Bas. Yay. Gıda San. ve Tic. Ltd. Şti.  
Hamidiye Mah. 7/Atatürk Bul. No:95A  
İç Kapı No: 1 Merkezi / AKSARAY  
Aksaray V.D. No: 1830691535 Tic. Sic. No: 8546  
Mersis No: 0183065155500010

TOPLAM ALAN : 163366.67 TOPLAM PAY : 163366.67 TOPLAM KAMULAŞTIRMA : 0.00 TOP. DÜZENLE. GİRMEYEN: 50920.70 TOP. DÜZENLEMeye GİREN: 112445.97				M A L S A H İ P L E R İ A R A Ş T I R M A V E Ö Z E T F O R M U ( K A D A S T R O P A R S E L İ N E S I R A L I )				SAYFA NO: 5 TOPLAM ADA ALANI : 77244.93 O.KATILIM ORANI : 0.0000000 D.O.PAYI ORANI : 0.3130485			
K A D A S T R O						İ M A R					
SNo	Pafta	Ada/Par	Alan/Pay	Hisse	Malik/Baba Adı	Kamu	Dop/İTh	Ada/Par	Alan	Hisse	Pay
					AYŞE YANBAŞ [Vrs.] ALİ YUSUF BOZLAK [Vrs.] ALİ						
93	L32-A-14-C	244/66	10546.1 2109.22	1 5	TEVEKKÜL BAYSAL RAMAZAN FATMA GÖKÇE [Vrs.] RAMAZAN SELMA KELEŞ [Vrs.] RAMAZAN AYŞE DİNÇ [Vrs.] RAMAZAN	-	660.28 1448.94	601/2	7244.67	144894/724467	1448.94

ÖMER BOZDOĞAN - BOZDOĞAN HARİTA ETÜT PL NI For Windows



**BOZDOĞAN**  
 Harita İnş. Bilgi. Bas. Yay. Grafik ve Tic. Ltd. Şti.  
 Hamidiye Mah. 7/Azrak Bul. No:95A  
 İç Kapı No: 1 Merkez / AKSARAY  
 Aksaray V.D. No: 183651585 Tic. Sic. No: 8546  
 Mersis No: 0183065155500010